

APPENDIX A

MAPS

**Proposed amendments to the
Premises Plan**

Cayton Bay Holiday Park

Proposed Outdoor Leisure Facilities - Proposed Liquor License Plan 2020/21

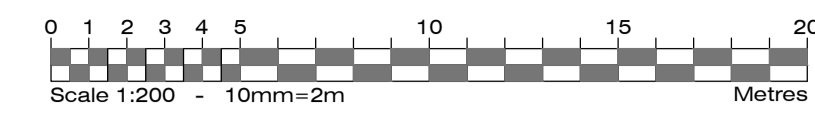
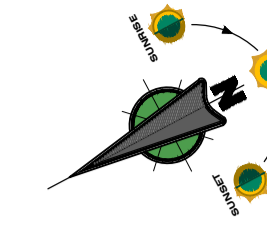

Copyright: This drawing is the property of A&M Architectural Partnership LLP. Its copyright and design content is reserved by them and the drawing is issued on the condition that it, is not copied, reproduced, retained or disclosed to any other unauthorized person, either wholly or in part without the consent in writing of A&M Architectural Partnership LLP.

Do not scale this drawing. Drawings can be scaled for Planning purposes only.

Verify all dimensions on site before commencing any work or preparing any shop drawings. All dimensions are in mm unless otherwise stated. Report any alterations or omissions to the Architect.

This drawing incorporates information from other professions.

A&M Architectural Partnership LLP cannot accept responsibility for the integrity and accuracy of such information. Any clarification and/or additions that are required appertaining to such information should be sought from the relevant profession or their appointed representative. All contractors and sub contractors are to comply in all respects with current building regulations whether or not specifically stated on these drawings.

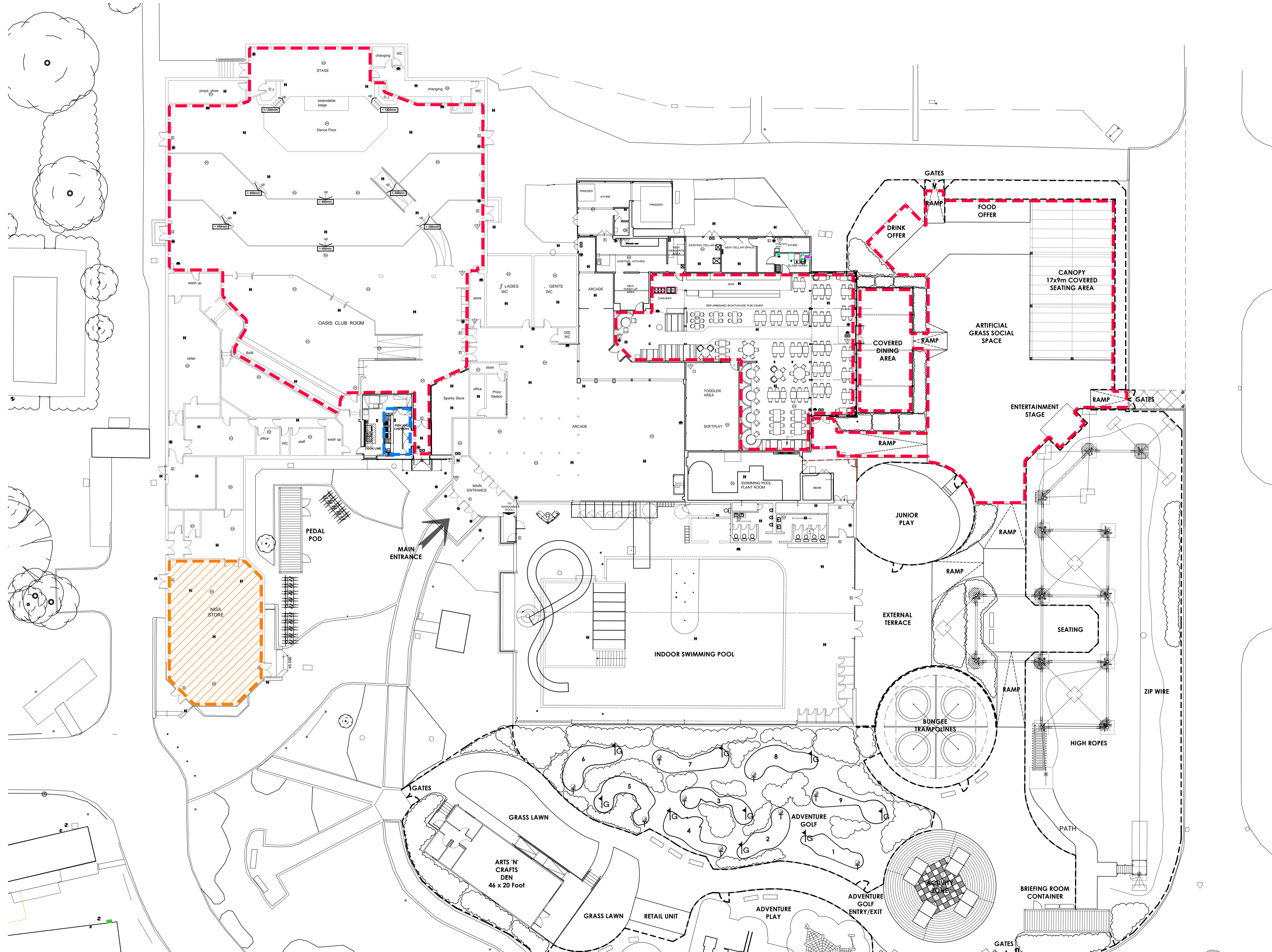

FIRE PRECAUTIONS SYMBOLS LEGEND

- Emergency Lighting Point
- "Fire Exit" sign
- "To Fire Exit" directional signs
- Illuminated "Exit" sign boxes
- Illuminated "Exit" directional sign boxes
- Fire extinguisher - water type
- Fire extinguisher - foam type
- Fire extinguisher - dry powder type
- Fire extinguisher - carbon dioxide type
- Fire extinguisher - vapourising liquid type
- Hose reel
- Fire blanket(s)
- Fire alarm call point
- Audible warning device
- Manual fire alarm sounder
- Visual warning device
- Automatic fire detector - heat/smoke
- Fire alarm indicator panel
- Change of height

- Area to be used for the sale & consumption of intoxicating liquor, the provision of late night refreshment and the provision of regulated entertainment.
- "Late Night Refreshments Only"
- Park Shop - Licensed by Third Party



Rev.	Details	Name	Date
A	Minor amendments.	tf	01.02.21



40 Cambridge Road, Hastings, East Sussex, TN34 1DT
 T: 01424 200222 W: amarchitectural.co.uk E: admin@a-and-m.co.uk

Client: **Parkdean Resorts Ltd**
 Site Address: **Cayton Bay Holiday Park**
 Mill Lane, Cayton Bay, Scarborough, Yorkshire, YO11 3NJ

Project: **Proposed Outdoor Leisure Facilities**

Drawing Title: **Proposed Liquor License Plan 2020/21**

Date: **Jan 2021** Scale: **1:200 @ A1** Drawn: **tf**
 Computer File Name: **4461-500-610-620 Proposed Alcohol - Gaming - Gambling Licensing Drawings.dwg** Checked By: **-**

Status: **Licensing**

Drawing Number: **4461-500** Revision: **A**

Welcome to CAYTON Bay

HOLIDAY PARK

BOATHOUSE BAR & RESTAURANT
 Open from Early - Late

PARK SHOP
 Open from 10am - 6pm

EXTERNAL AREAS
 REQ. ENT.

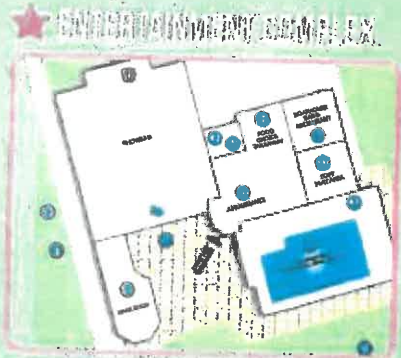

PLEASE NOTE - Passes are required for admission to all facilities
 Please carry your Holiday Passes with you at all times.

5

Speed limit around the Park is 5mph

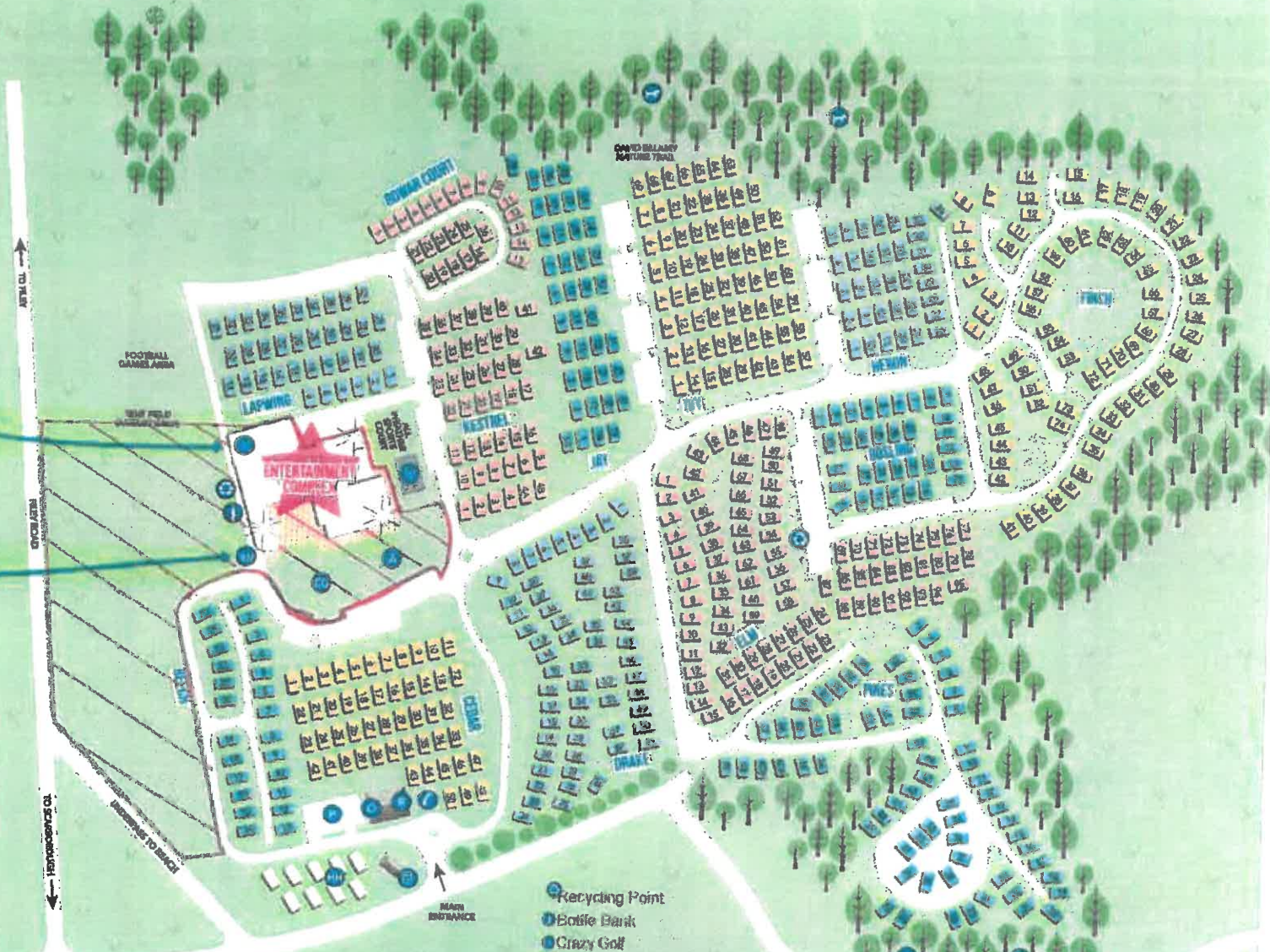

- Soft Play Area
- Boathouse Bar & Restaurant
- Waterworld Fun Pool with Fibre
- Toilets
- Sparky's Krew
- Dog Walking Area
- Sparky Store
- Park Shop
- Toilets / Disabled Toilets
- Recycling Point
- Bottle Bank
- Crazy Golf
- Adventure Playground
- Telephone
- Reception
- Amusements
- Parking
- Laundryette
- Owners Enquiry Office
- All Weather Sports Court
- Holiday Home Sales Office
- Disabled Access
- Food Choice Takeaway